

US Energy Storage System

Commission Guide

Issue: V1.4b

Date: 2025-08-25

FOXESS CO., LTD.



Commissioning

Step 1: scan the QR code to download FoxCloud2.0 app and download the app.

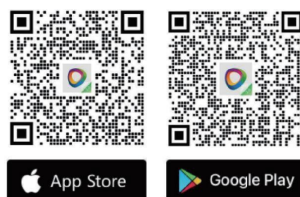

After the app is installed, the FoxCloud2.0 icon is displayed on the home screen.



FoxCloud2.0

Step 2: Initial App Configuration (First Download Only)

- Tap **"Getting Started"**, select **"North America"**.

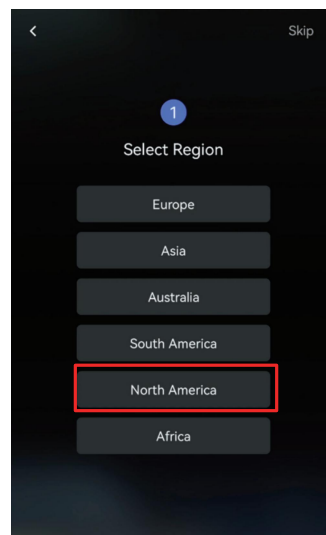
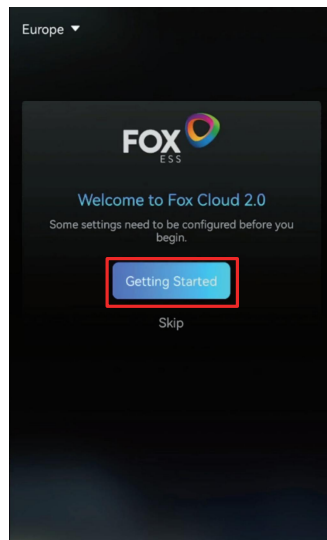

- Create an account.
For installers/distributors

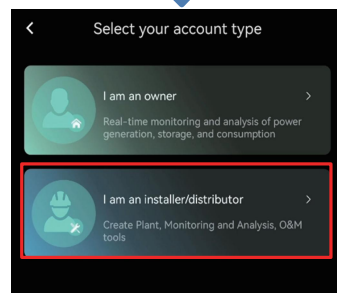
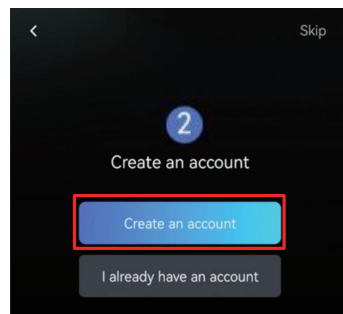

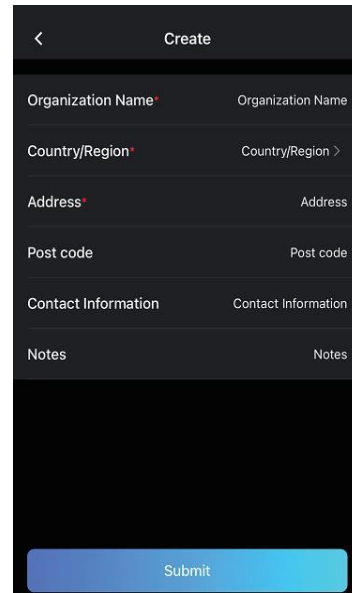
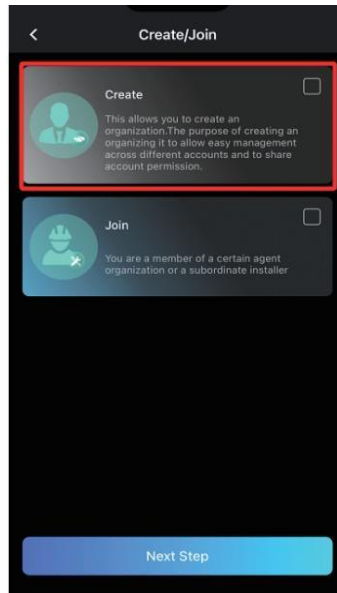

- Connect to the network. Turn on the Bluetooth of your phone in advance.

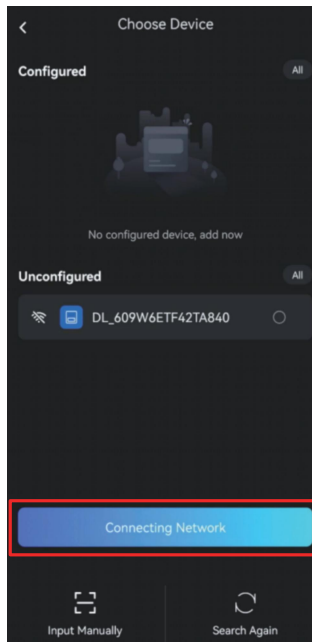
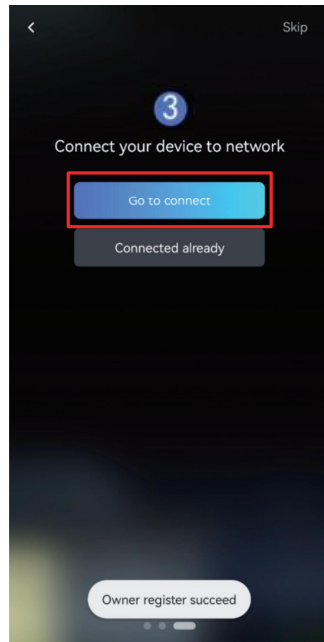

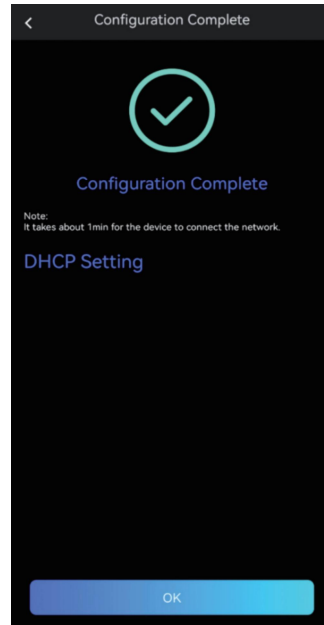
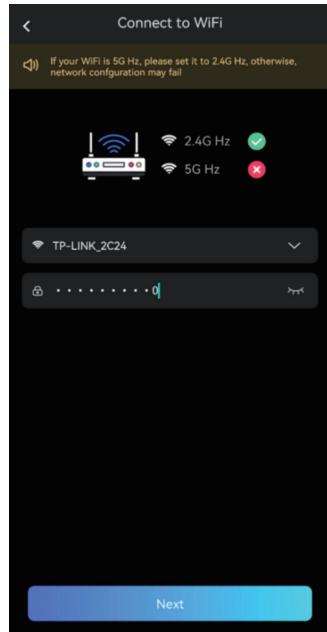

Step 3: Tap “...” at the right corner, select “**WLAN Configuration**”.

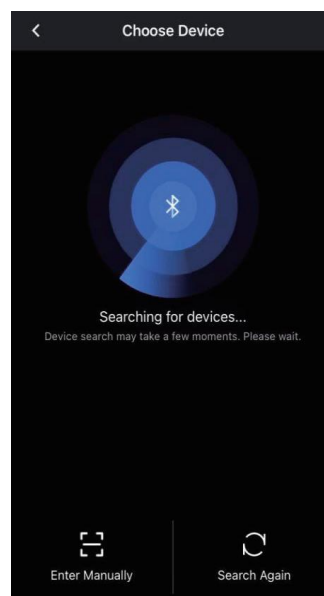
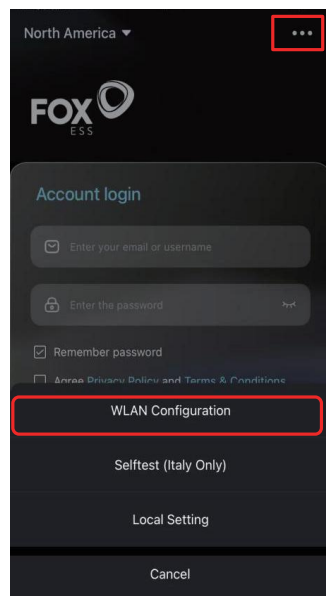

Or, manually enter the SN code on the Smart WiLAN.

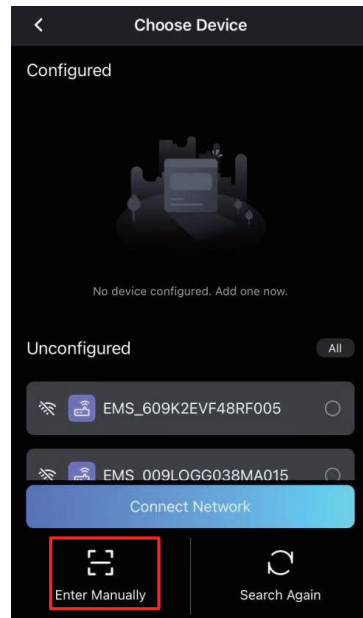

Light indication on the Smart WiLAN

Indicator	Status	Instructions
Red light	Blinking	Not connected to the server
	Solid on	Connected to the server
Green light	Blinking	Data transmission

Step 4: Sign in the installer's account. Tap **"Create a plant"**.

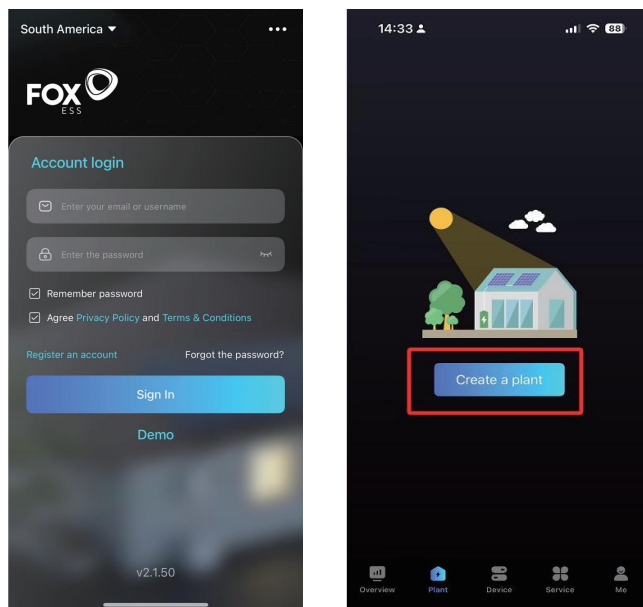

Scan the QR code on the Smart WiLAN or enter the SN code, and fill the information.

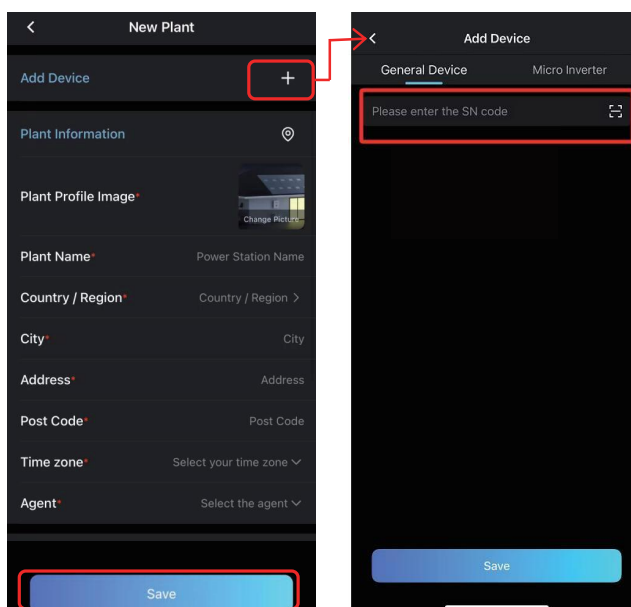

Step 5: Check system performance on “**Plant**” dashboard.

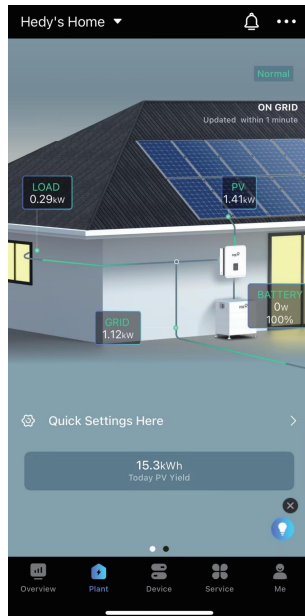

Step 6: Use the checklist below to make sure the necessary items are completed.

Item	Necessary or Optional	Status (✓ if completed)
1. Time Zone	Necessary	
2. Energy Mode	Necessary	
3. Zero Back-feed	Optional	
4. Service Panel Parameter	Optional (Only needed when the FOX Hub G2 is not used as a service panel)	
5. Grid Code	Optional (Only needed when selling to countries except US; Change “USA” into your own country)	
6. Existing Solar Inverter Power	Optional (Only needed in Existing System)	
7. Charge from Grid	Optional (Only needed when main breaker cannot support inverter output during full load)	

Item 1: Set up the time zone on the “**Plant**” dashboard.

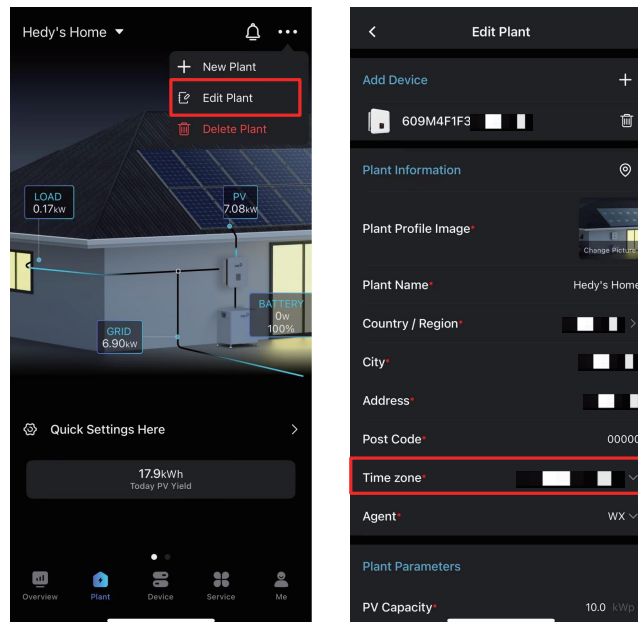

Item 2: Configure the energy management mode on the “**Plant**” dashboard.

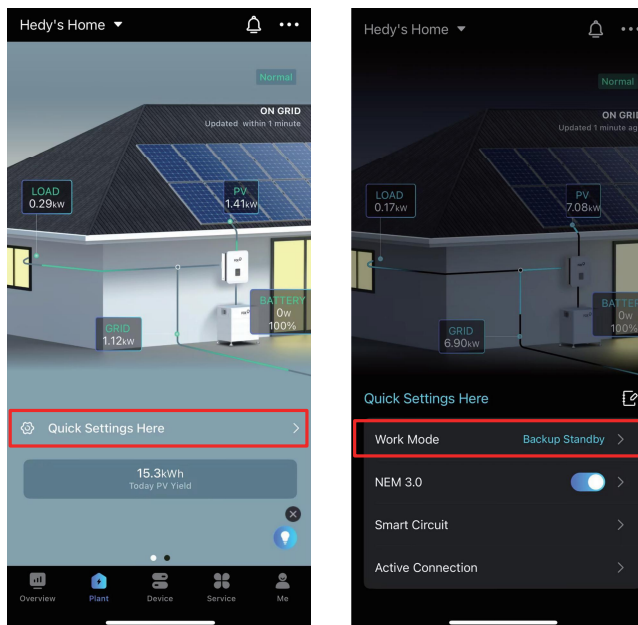

Item 3: Set the zero back-feed on the **“Device”** dashboard.

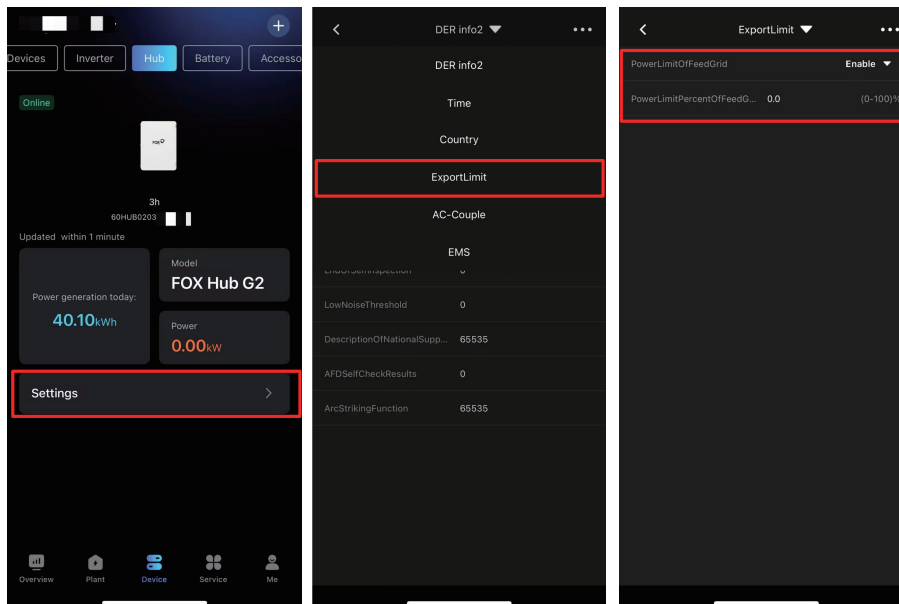

Item 4: Set service panel parameters on the **“Device”** dashboard.

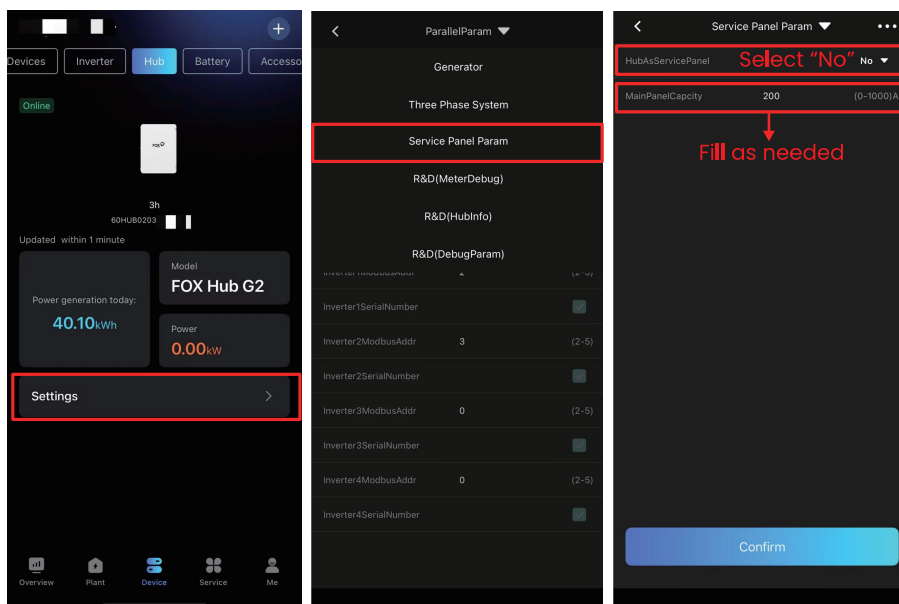

Item 5: Set the grid code on the “**Device**” dashboard.

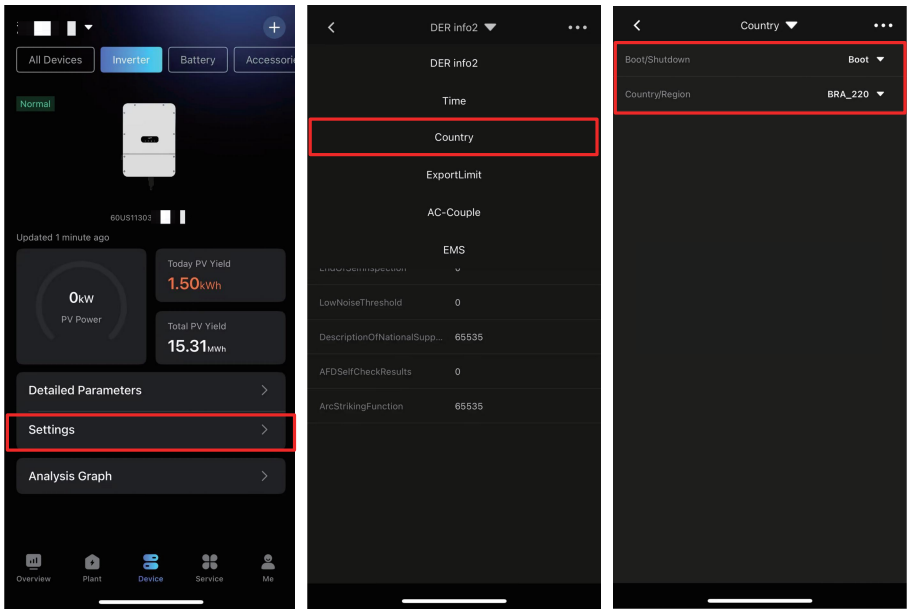

Item 6: Set the existing solar inverter power on the “**Device**” dashboard.

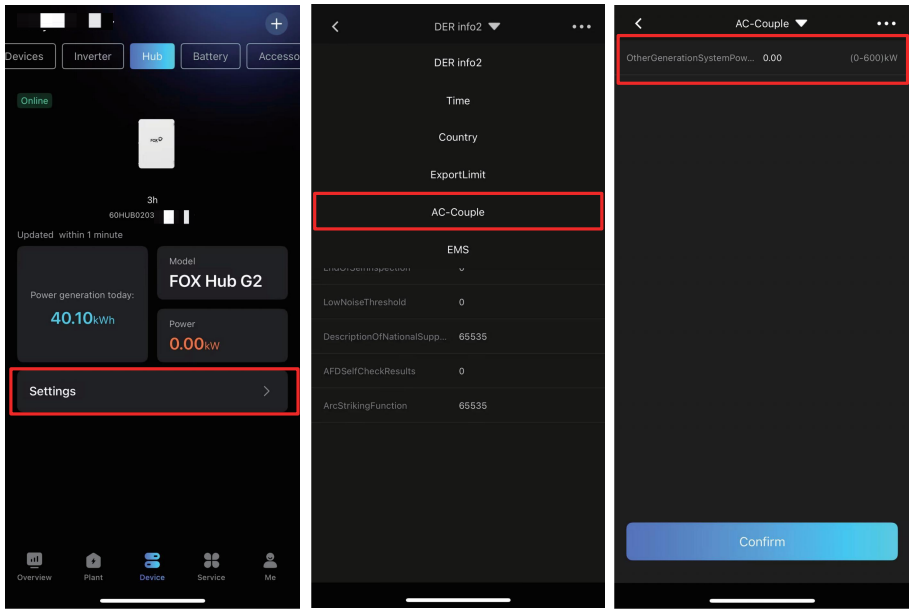

Item 7: Set the the charge by grid value on the “**Device**” dashboard.

