

Meter Collar Hub

Quick Installation Guide

Issue: V1.0

Date: 2025-11-26

FOXESS CO., LTD.



Notice

1. The information in this document may not be modified, copied or reproduced, in whole or in part, without the prior written permission of FOXESS CO., LTD. All information in this document is provided to the best of our knowledge and efforts, but does not constitute a warranty of any kind, express or implied. You can download quick guide and user manual by scanning the QR code.



2. Only certified electricians are allowed to operate the device. Operation personnel must wear proper personal protective equipment (PPE).

3. Before installing the device, check that the package contents are intact and complete against the packing list. If any damage is found or any component is missing, contact your dealer.

4. The device damage caused by the violation of instructions in this document is not covered under warranty.

5. The cable colors involved in this document are for reference only. Select cables in accordance with local cable specifications.

1 Packing List

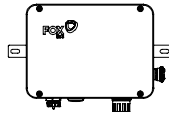

A



B



C



D



E

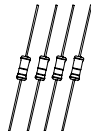

F



G

OBJ	QTY	DESC	OBJ	QTY	DESC
A	1	Meter Collar Hub	E	1	Smart WiLAN
B	2,2	Self-tapping screw M6×40, Expansion Tube Ø8×40	F	4	60Ω Terminating Resistor
C	2,2	Hexagon Bolt M6×45, Flange Nut M6	G	1	Quick Installation Guide
D	1	100A Current Transformer			

2

Installation Steps

2.1 Size

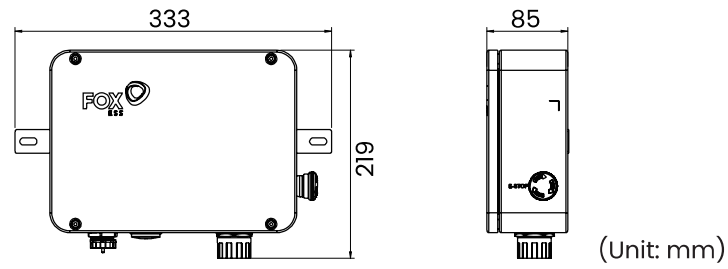

2.2 Installation Space

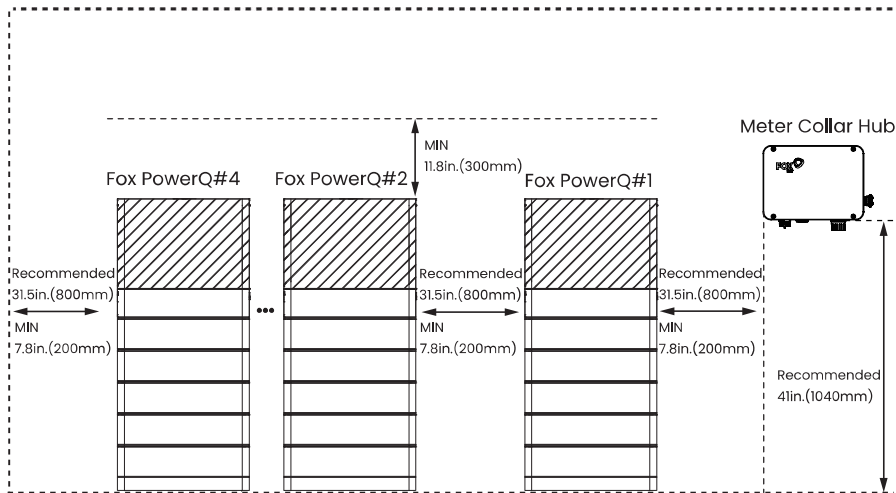

NOTE:



Take Fox PowerQ as a representative example. The actual installation shall be based on the inverter model available on site.

2.3 FOX Hub G2 Installation (Optional)

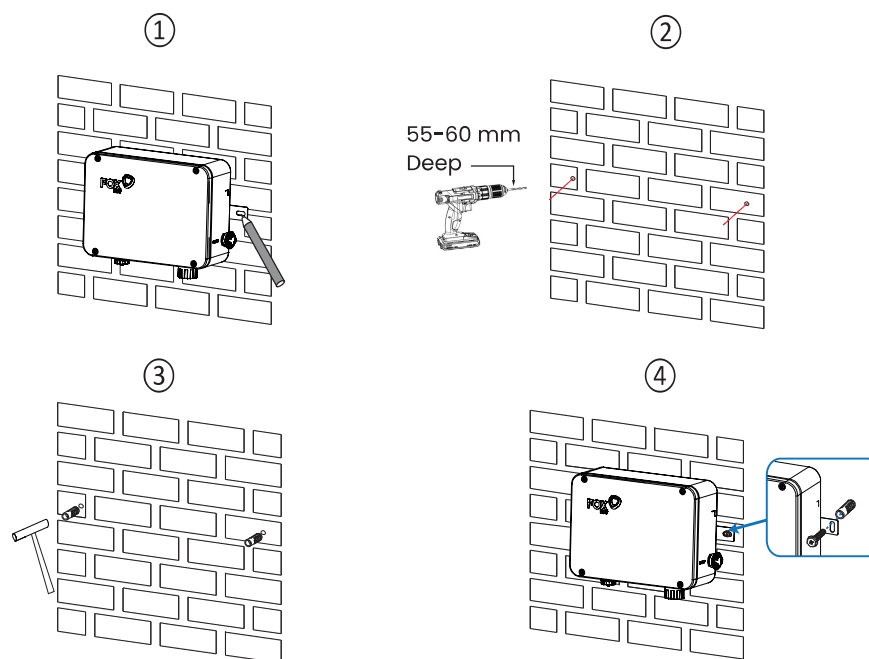

3 System Wiring Diagram

NOTE:



This system diagram uses Fox PowerQ as a representative example. The actual installation shall be based on the inverter model available on site.

3.1 DC Couple

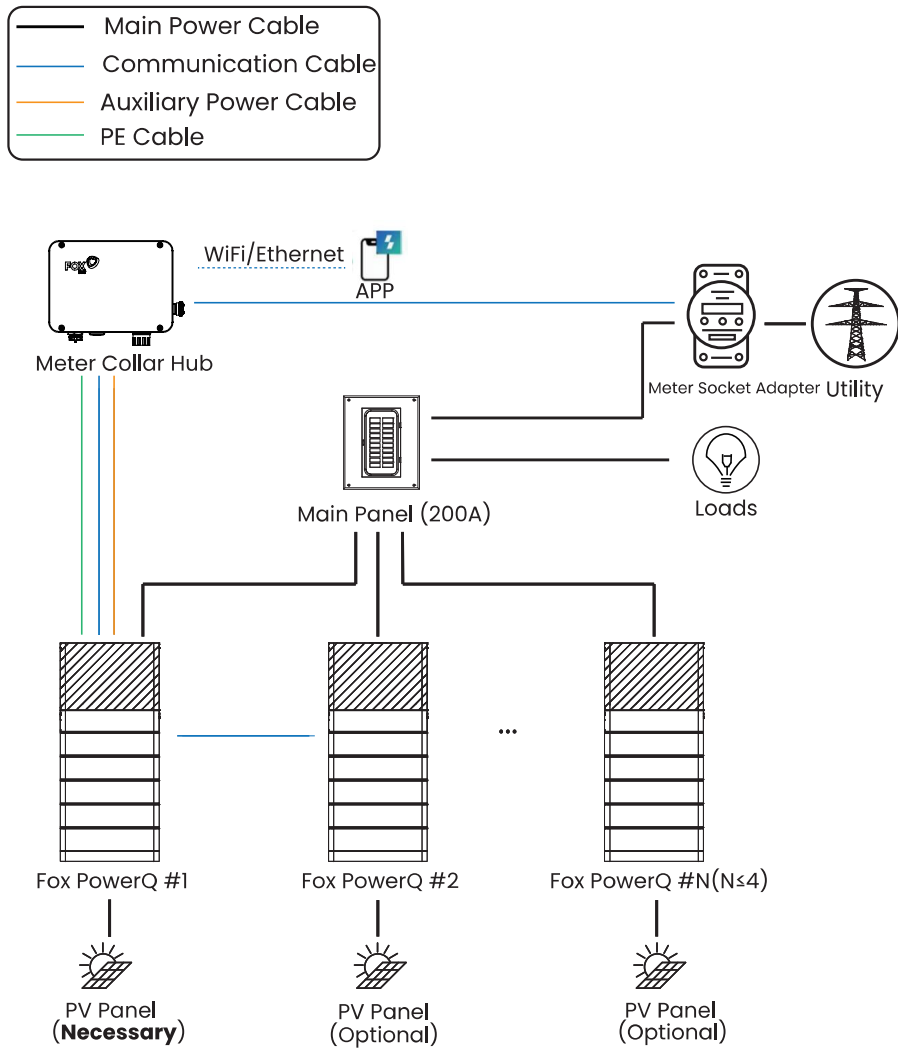

3.2 AC Couple

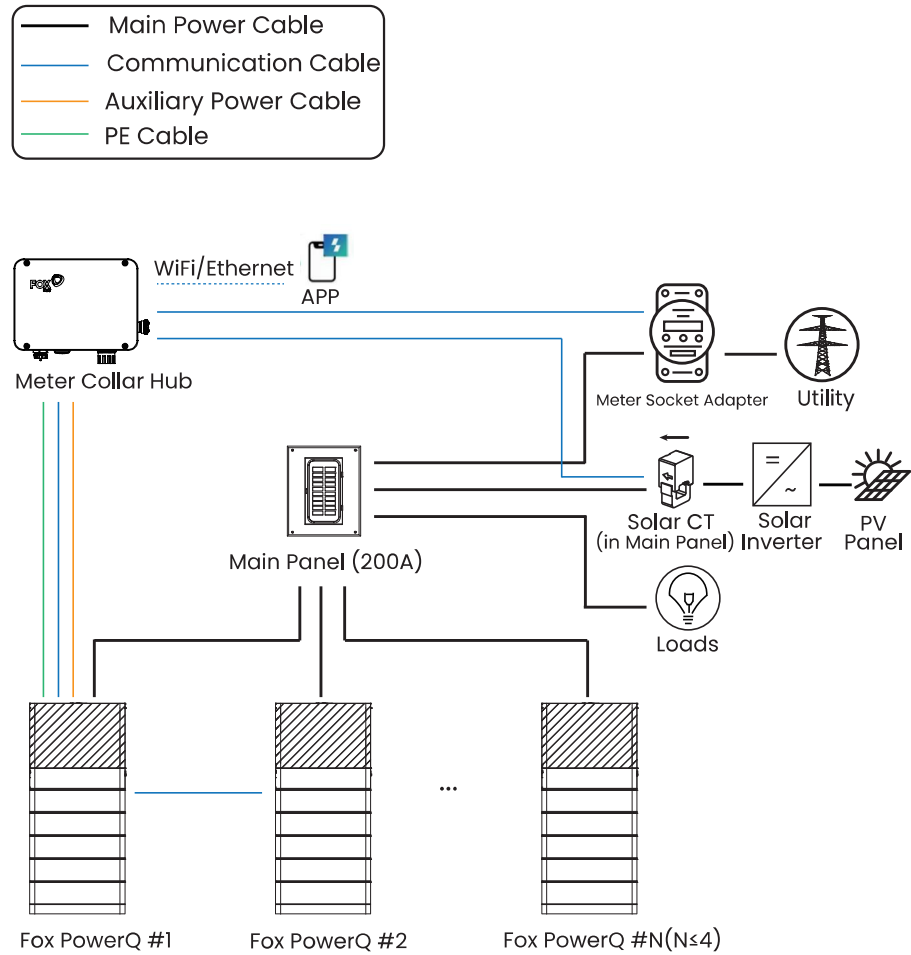

4 Wiring Steps

4.1 Connecting to inverters

 16 AWG	 16 AWG	 24-16 AWG
 24-16 AWG	 24-16 AWG	 24-16 AWG

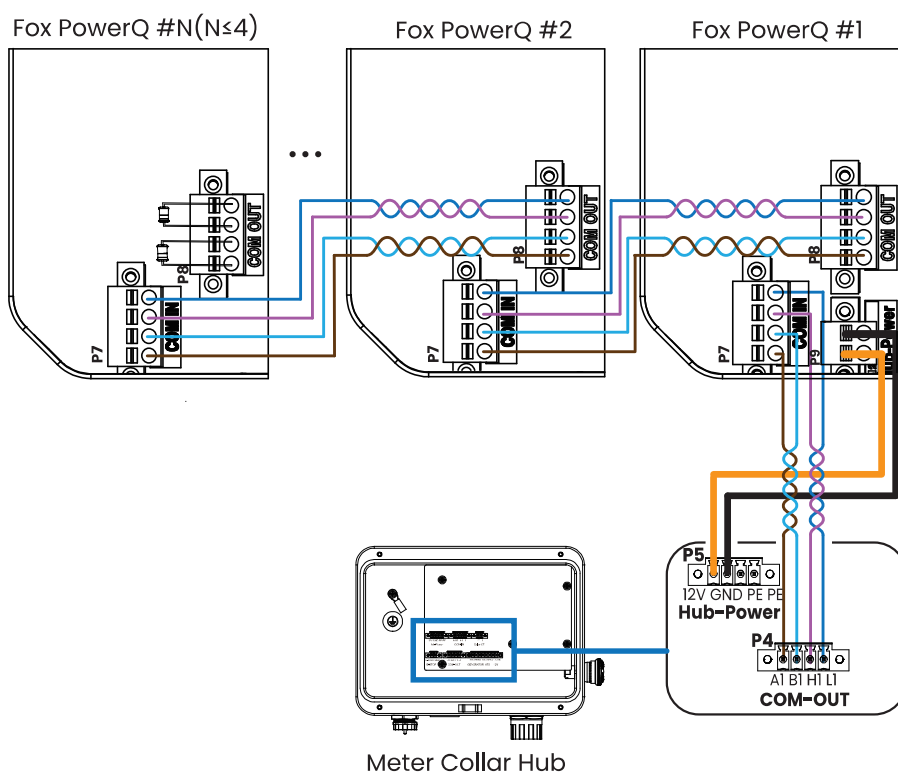

NOTE:

- ① Remove resistors on P8 sockets of Fox PowerQ units except the last one.
- ② The twisted cables use shielded twisted pair with drain wire (minimum CAT5e network cable).
- ③ The maximum cable lengths between Meter Collar Hub and Fox PowerQ #1, and between Fox PowerQ units are 50m and 5m, respectively.

4.2 Connecting to Solar CT (Only for AC Couple)

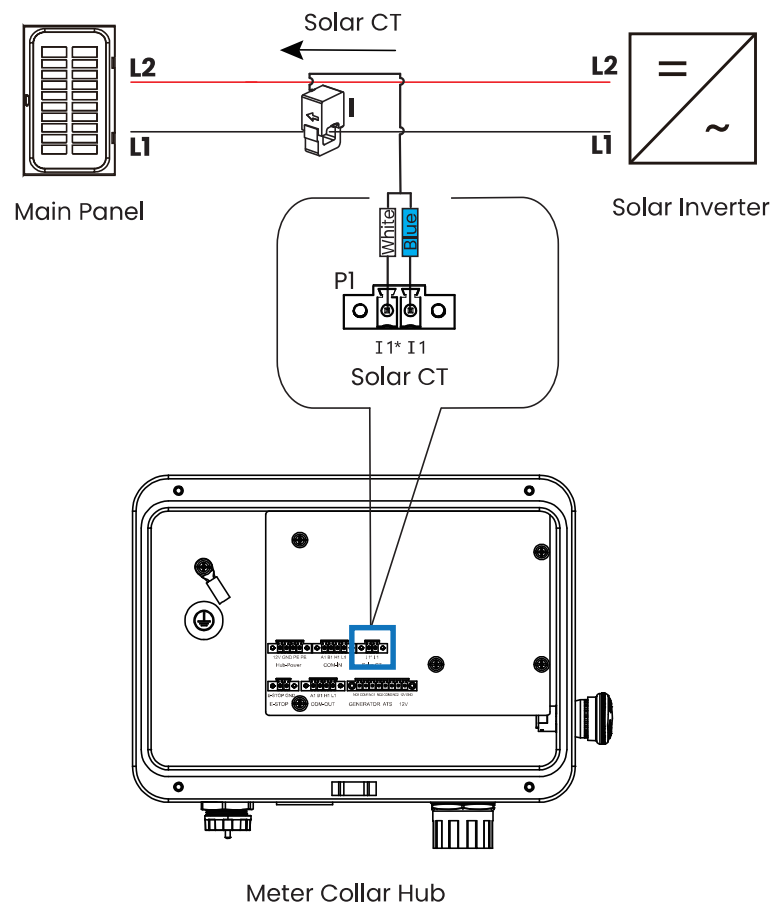

4.3 Connecting to E-STOP (Optional)

NOTE:

- ① Meter Collar Hub is provided with an E-STOP on the right side cover. If an additional E-STOP is needed, firstly remove the jumper on the P6 socket.
- ② The additional E-STOP is required to have normally closed contacts.

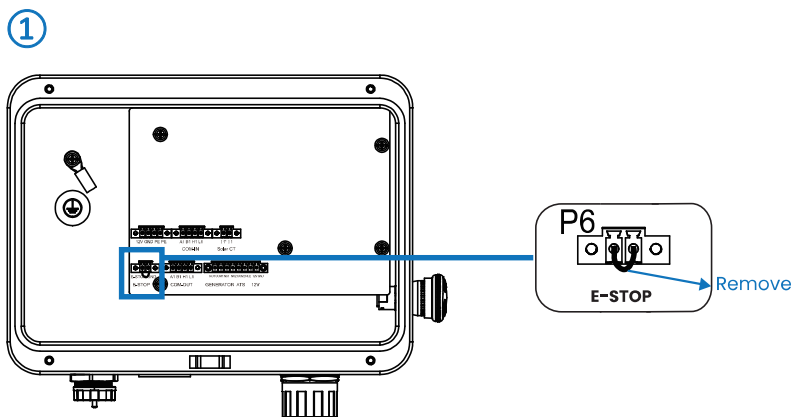

Meter Collar Hub

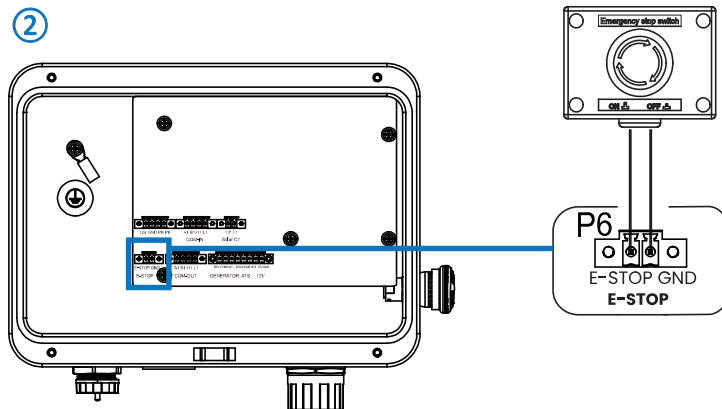

Meter Collar Hub

4.4 Ground Wiring

①

M4
C 2.0 N.m

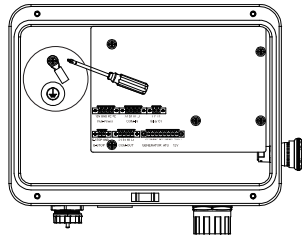

②

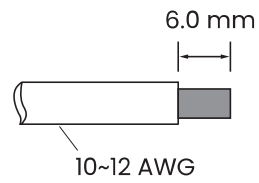

③

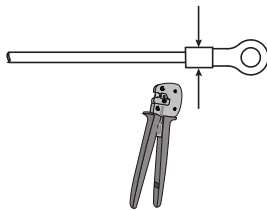

④

M4
C 2.0 N.m

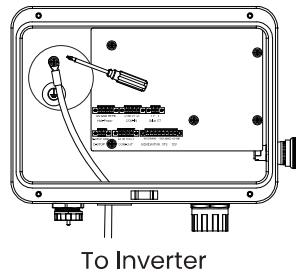

4.5 Connecting to Smart WiLAN

- WiFi Installation: connect the Smart WiLAN to the Meter Collar Hub.

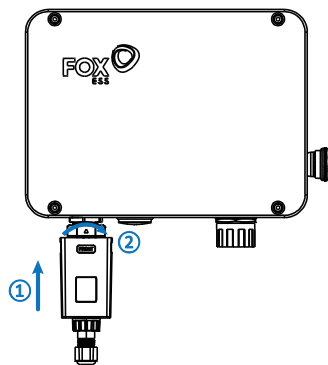

- LAN Installation: insert the network cable into the Smart WiLAN, and connect it to the Meter Collar Hub.

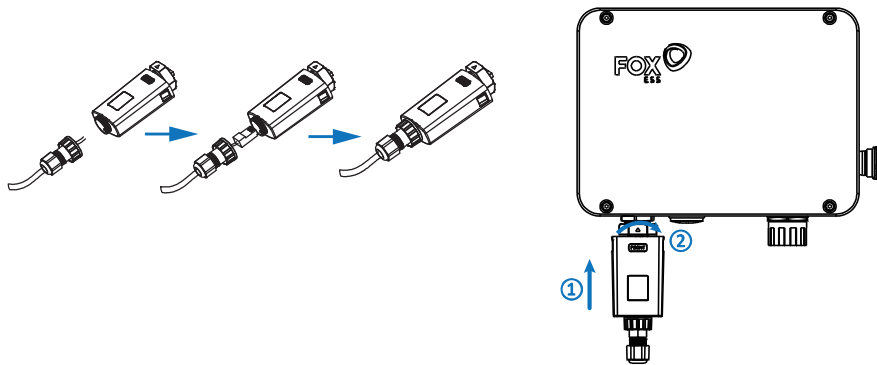

4.6 Connecting to Meter Collar

- Align the master keyway in the communications cable plug with that in the circular connector receptacle.

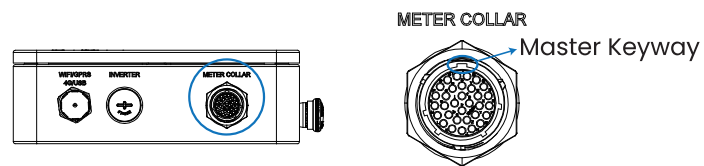

- Insert the communications cable plug into the circular connector receptacle. Tighten it securely.

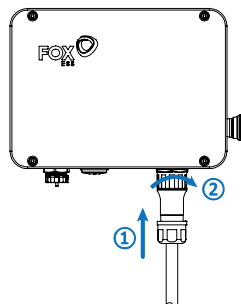

NOTE:

 The meter collar is integrated with a 6 ft. communications cable. Longer lengths up to 25 ft. may be possible by special order.



V1.0

99-203-00581-00